

TECHNICAL DATA SHEET

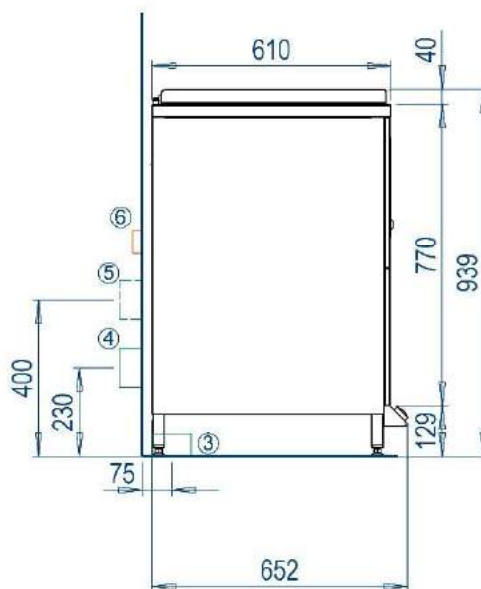
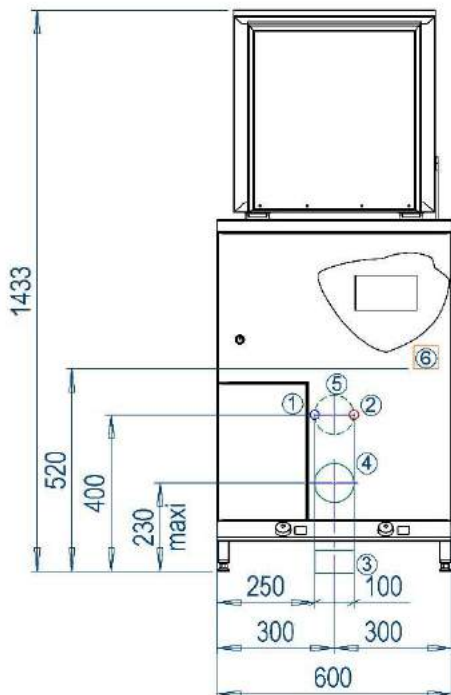

OPTIMAL INSTALLATION DATAS

1. Cold water supply : flexible F3/4" lg 1m
Stop valve ¼ turn M3/4" to provide (vertical)
Minimum pressure : 1 bar
Minimum flow rate : 16 l/min
2. Hot water supply : flexible F3/4" lg 1m
Stop valve ¼ turn M3/4" to provide (vertical)
Minimum pressure : 1 bar
Minimum flow rate : 16 l/min
Minimum Temperature : 55°C
3. Floor exhaust : Ø100 mm inside the pipe
4. Inclined wall exhaust : Ø100 mm inside the pipe
5. Wall exhaust straight : Ø100 mm inside the pipe
6. Electric power supply cable IP55: lg 1,5m
230V/50Hz 1N+PE, 16A
400V/50Hz 3N+PE, 10A
Dedicated electric supply,
Connection to the earth compulsory and under the
mandatory norms. Différentiel protection of 30mA
7. Floor load : 95 kg (81 kg empty)

CONSUMPTION (PER CYCLE)

Standard Cycle

Cold water : 8 L
Hot water : 10 L
Arcania detergent 3500 ADLB : 15mL

Intensive cycle

Cold water : 8 litres
Hot water : 18 litres
Arcania detergent 3500 ADLB : 15mL

Consumption of electricity maximum : 3kW

TECHNICAL INFORMATIONS

standard cycle : 5 minutes

Intensive cycle : 6 minutes

Noice level : 50 decibels

Complies with the following norms :

NF EN ISO 13485, NF EN 15883-1, NF EN 15883-3,
NF EN 61010-2-040, NF EN 60601-1-2,
NF EN 60601-1-4, NF EN 62304, NF EN 62366